

Use this end of the pole

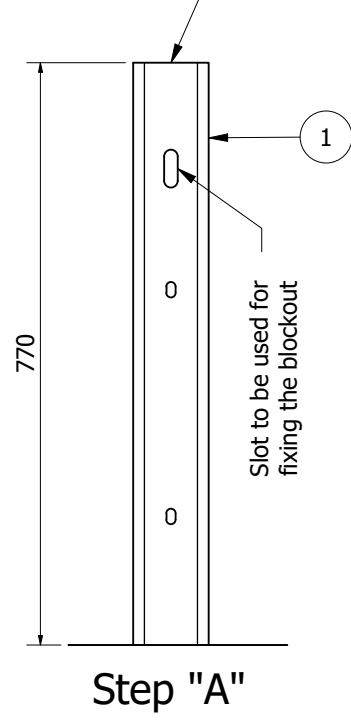

Slot to be used for fixing the blockout

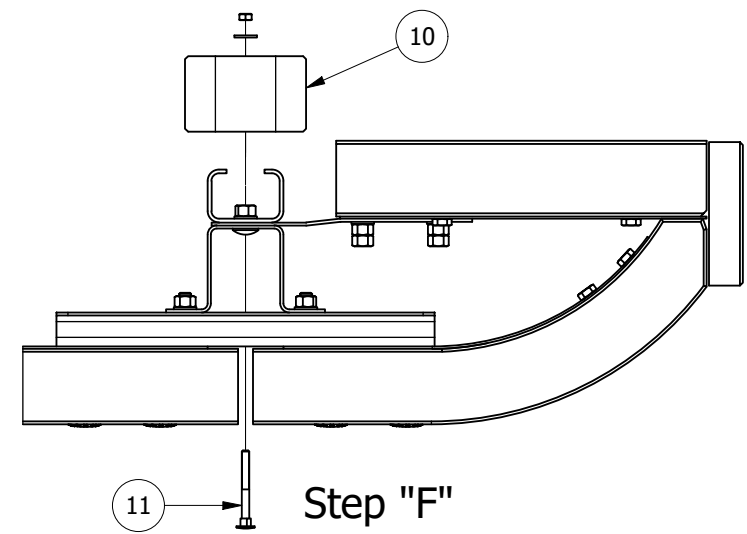
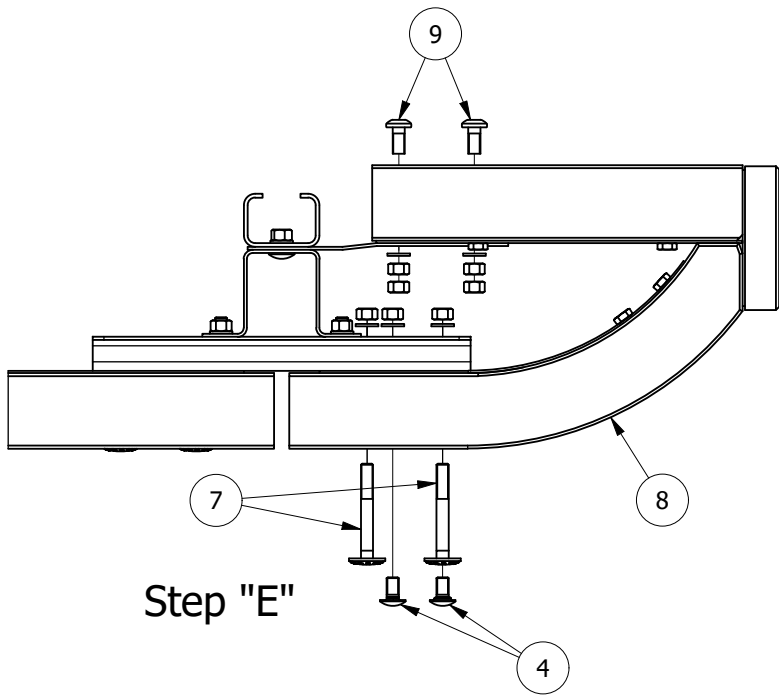
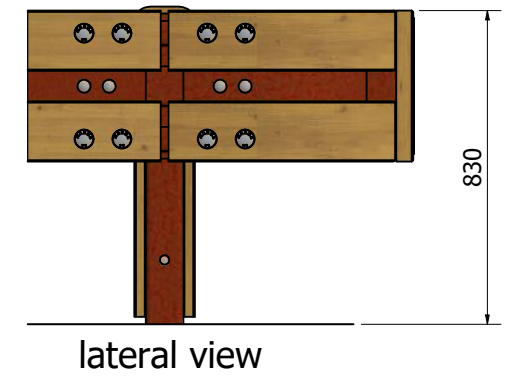
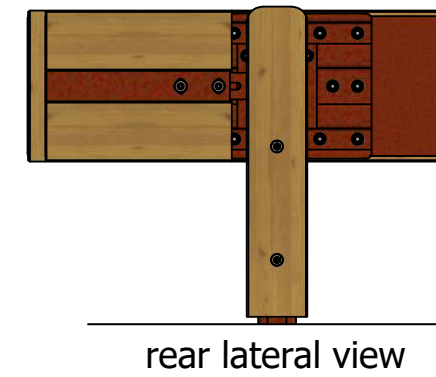
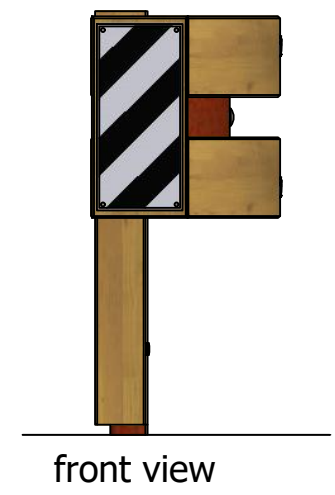
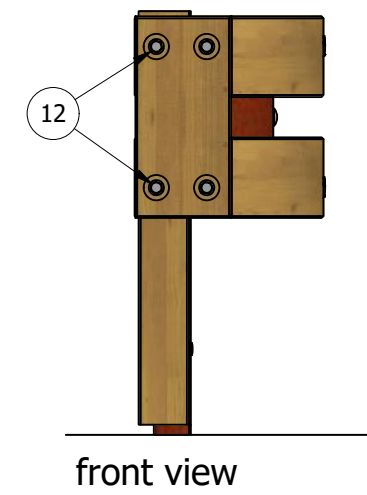
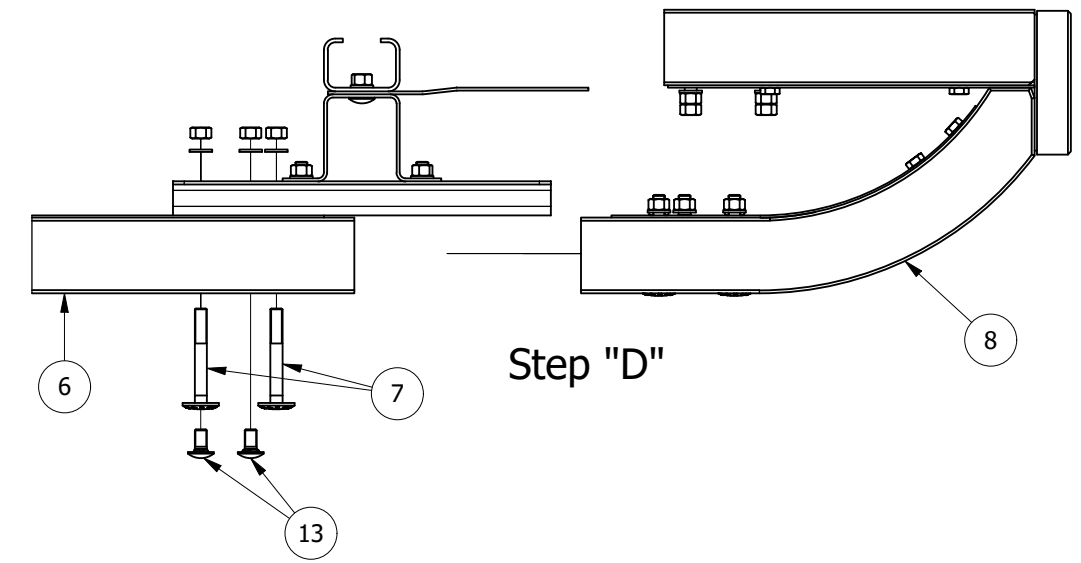
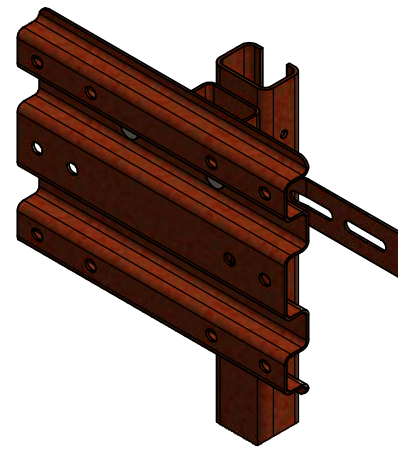
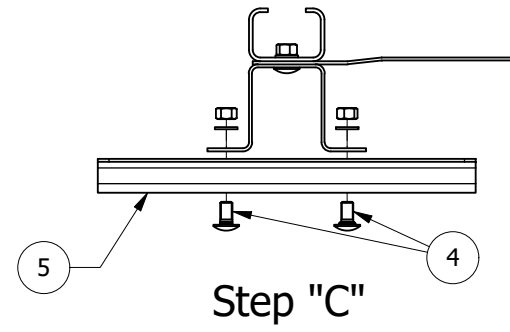
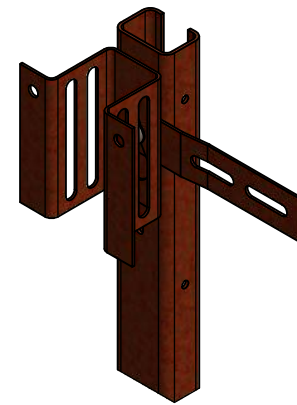
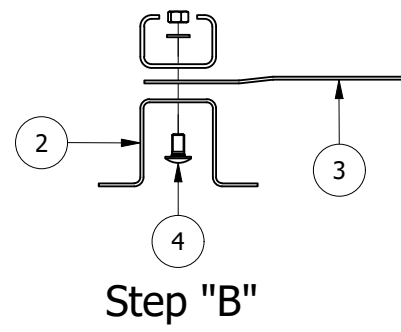

Measurements expressed in mm

**Tightening torque:**

- Ref. 4 120 Nm
- Ref. 7 & 13 torque between 150 & 200 Nm
- Ref. 9 tighten with nut and locknut

The torque values must be checked with a calibrated torque wrench  
**NB** Carry out the indicated dimensions with extreme accuracy

Component list	
Ref.	Item
1	"C" post
2	Blockout
3	Bracket
4	Bolts TT M16x30
5	Corrugated Splice plate
6	Protection rail
7	Bolts TTQST M16x125
8	T50 Terminal
9	Bolts TT M16x35
10	Single post cover
11	Bolts TTQST M10x100
12	Wood screw 14x60 & M16 washer
13	Bolts TT M16x30



**MARGARITELLI**  
**ROAD SAFETY**

Drawing IM 034-01	Issued 19/12/2022
Review 00	Date --/------

**Object:** Energy absorbing terminal T50 class - T50-01  
 Tested for T50 Class in compliance with CEN/TS Terminals  
 Assembly instructions